

D SERIES

LIGHTWEIGHT COMBI-BUNKS THAT MAKE THE MOST
OF THE MATERIAL'S GREATEST ASSETS

ExTe

Securing cargo. We invented the concept.

OPT
IMI
SED

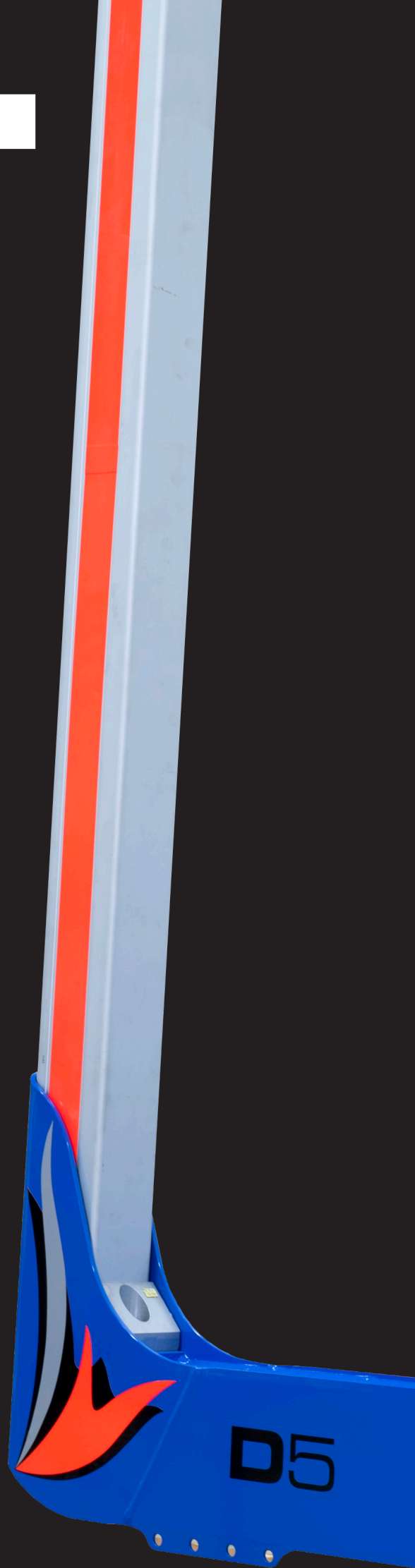

HIGH TENSILE STEEL OFFERS NEW OPPORTUNITIES

More profitable transportation

High tensile steel bolsters and aluminium stakes also contribute to greater road safety and more profitable timber transportation for the hauliers.

The lightest and strongest on the market

The D-bunks make the most of the steel's unique assets when it comes to strength. Combined with aluminium stakes, they offer the strongest and most lightweight combi-bunks on the market.

Functional design

The design focuses on the strength and relatively low weight of the D-Series.



Load more timber

The D-bunks are lightweight relative to their load capacity. The bunks therefore enable you to transport more timber per load. Which is good for the hauliers' profitability.

Several different attachments

When installing the bunks, there are several different attachments to choose from, such as the clamp attachments, the combi attachments and adjustable friction mount.

Bunks for all transportation needs

The D-bunks are available in various load widths and load heights, to meet the needs of the various different markets.

WE LISTEN, BUILD AND TEST.

At ExTe, listening to ideas and feedback from hauliers, drivers and body builders is in our genes. It is often the basis for the development of new products with unique, practical solutions. All new products undergo extensive testing, both in the laboratory and through extensive trial use in practice, before they are released into the market. All in the name of maximising safety and functionality.





FOUR BASIC ALUMINIUM STAKE DESIGNS.

Telescopic stakes enable adjustments to be made, for flexible load heights, without the need to switch stakes.

Three solid stakes, two of which are tapered - one inwards and the other outwards.

The stakes are available in various different heights.

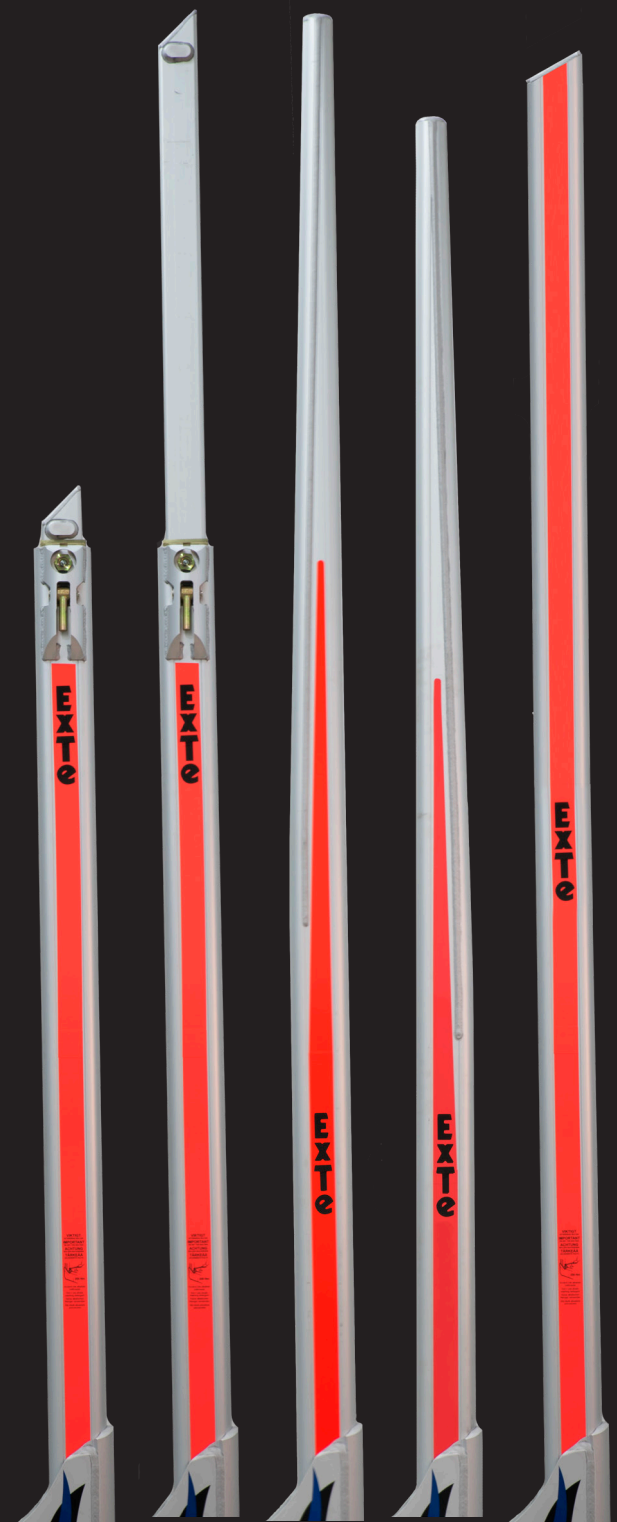

WE'VE THOUGHT OF EVERYTHING.

D-SE

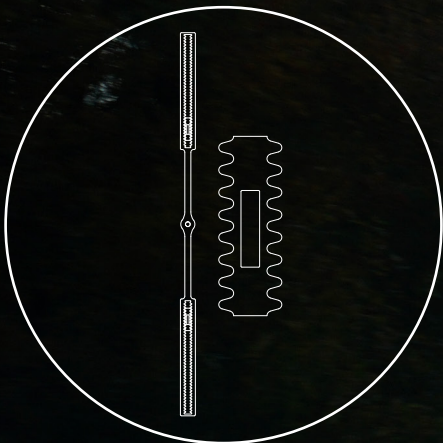

Unique combi attachments

This mount is a combination of the friction and clamp techniques. Clamping the mount means that drilling the bolster is no longer necessary.

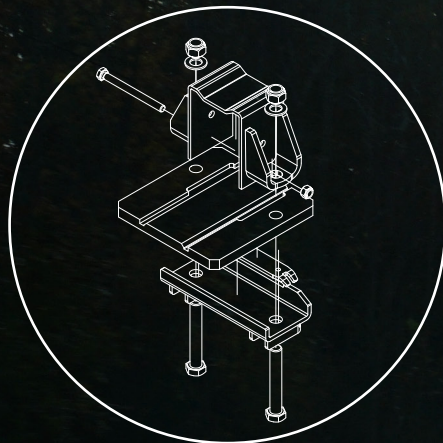

Lightweight clamp attachments

With the lightweight clamp attachments and plastic panel, installation is quick and simple.

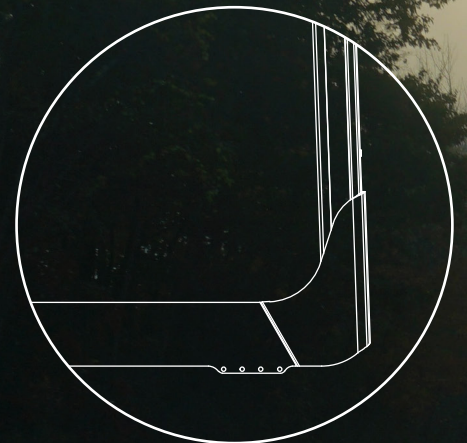

TU-ready

The bolsters are pre-drilled for subsequent assembly of our practical attachments below the bolster. No welding is necessary.

ERIEO

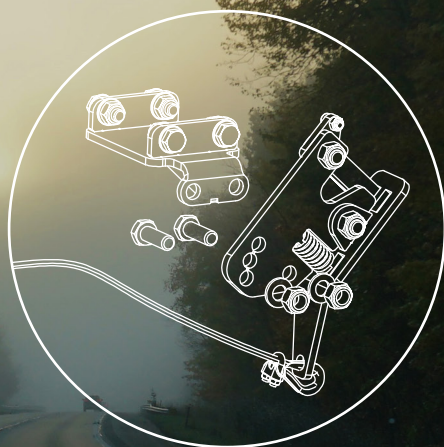

Single or double release

The manual release is screwed onto the bolster with a single mount or, if two releases are required, with a double mount.

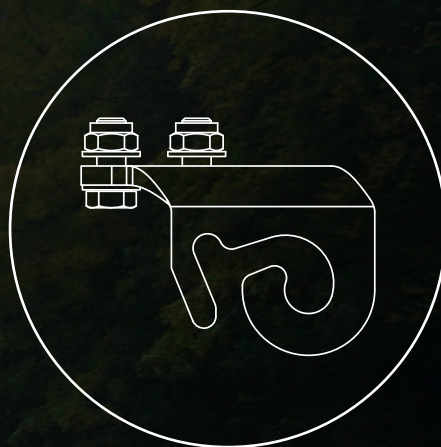

Easy to install accessories

The bolsters have been designed so that the various different accessories can easily be attached, such as the pneumatic release or lighting.

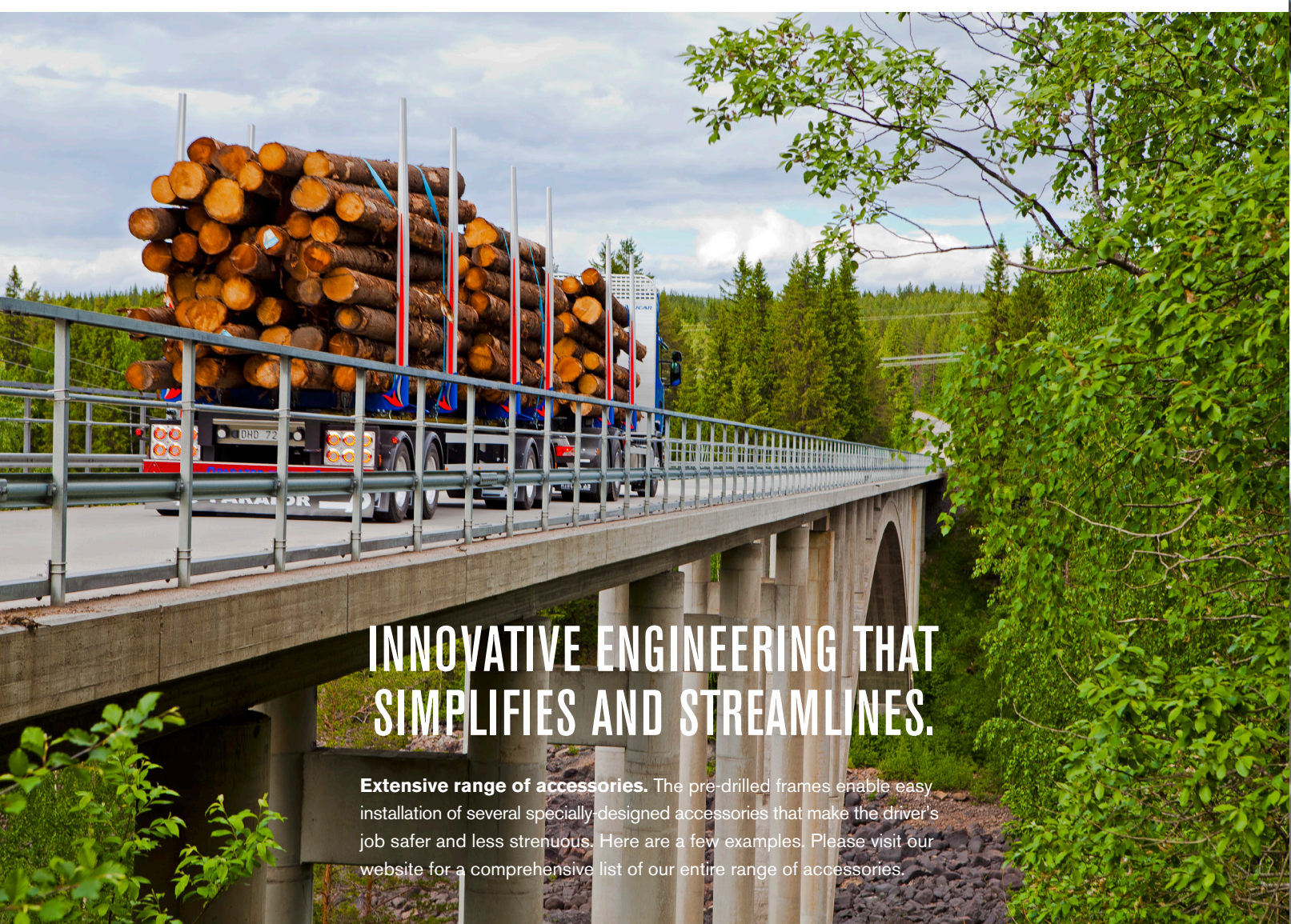

INNOVATIVE ENGINEERING THAT SIMPLIFIES AND STREAMLINES.

Extensive range of accessories. The pre-drilled frames enable easy installation of several specially-designed accessories that make the driver's job safer and less strenuous. Here are a few examples. Please visit our website for a comprehensive list of our entire range of accessories.

THE HOOK

helps you lift chains/straps more easily.



The hook has been designed so it can be easily lifted with the grapple. Both the hook and the holder are made from specially-designed, durable rubber. The holder is easy to mount on the stake and has been designed to ensure the hook remains in place even during transportation. Our hook solution is gentle on the body and increases safety, while also speeding up the lashing process.

THE CHAIN HOLDER

for assembly on stakes.



Hang the chain on the stake quickly and simply. For right-hand or left-hand assembly. As the hole configurations are the same, it can be attached with the hook holder to the pre-drill holes.

HOOKS AND HOOPS

secure and functional lashing attachments.



Both the hooks and hoops are made from high-tensile steel. They are bolted to the release mounting.



THE CRANE GUARD

minimises major damage to cranes and bunks.



When idling, the crane rests on a bunk. Bunks and crane booms get damaged and worn during transportation. The design of the crane guard, with a robust rubber girder attached to the bunk, absorbs shocks and vibrations, thereby protecting against damage.

TU TENSIONERS

automatic, compact and flexible.



On timber rigs, TU tensioners are mounted onto bunks or frames. The symmetric design (right/left) means that strap drums, as well as release levers, can be attached to either side, depending on specific needs or preferences. The TU tensioner has been designed to secure all types of heavy goods loads for transportation, whether it be timber or any other type of cargo. Pneumatic disengaging of the tensioning mechanism is an optional extra. With this option, the tensioner can be disengaged at the touch of a button from inside the cab.

REMOTE CONTROLLED RELEASE MECHANISM

makes the job easier and safer.



The benefit of a pneumatic release mechanism is that the driver does not have to walk round and release every single lashing individually. Using just one hand, from inside the cab, the lashings on all of the stacks can be released simultaneously. Once the lashings have been released, the strap coils up automatically. Simple and practical. If you only need to release the lashing on individual stacks, then you still have the cable release.



A NETWORK OF DISTRIBUTORS

ExTe has a well-established network of distributors around the world. This is who hauliers should contact in the first instance. Most of the distributors are qualified body builders and service technicians, and are located near the hauliers. That is where the most common products and spares will be in stock. But it goes without saying that everyone is welcome to contact the ExTe sales team directly.



TECHNICAL SUPPORT

ExTe's Technical Support team is global and they are always available for hauliers, body builders and service technicians. In the event of a problem, things can usually be resolved over the phone straight away. An important function for our Technical Support team is carrying out planned and preventative inspections at the hauliers. The Technical Support team is also usually involved the first time an upfitter installs an ExTe product, in addition to providing training for assembly and warehouse staff.



WE OWN THE PATENTS

"Securing cargo. We invented the concept." And we have been coming up with solutions to improve safety and quality for hauliers since 1898. Today, ExTe has a wide range of unique, patented solutions. ExTe's patent symbol indicates something unique and which is only available from ExTe. That ExTe has something which no-one else has.



D5

D5 - Timber Bunk.
Max. load per bunk: 5 tons.
Weight from 90 kg.

D7

D7 - Timber Bunk.
Max. load per bunk: 7 tons.
Weight from 99 kg.

For the D-bunks, there are both fixed stakes for various load heights as well as telescopic stakes.

D10

D10 - Timber Bunk.
Max. load per bunk: 10 tons.
Weight from 130 kg.

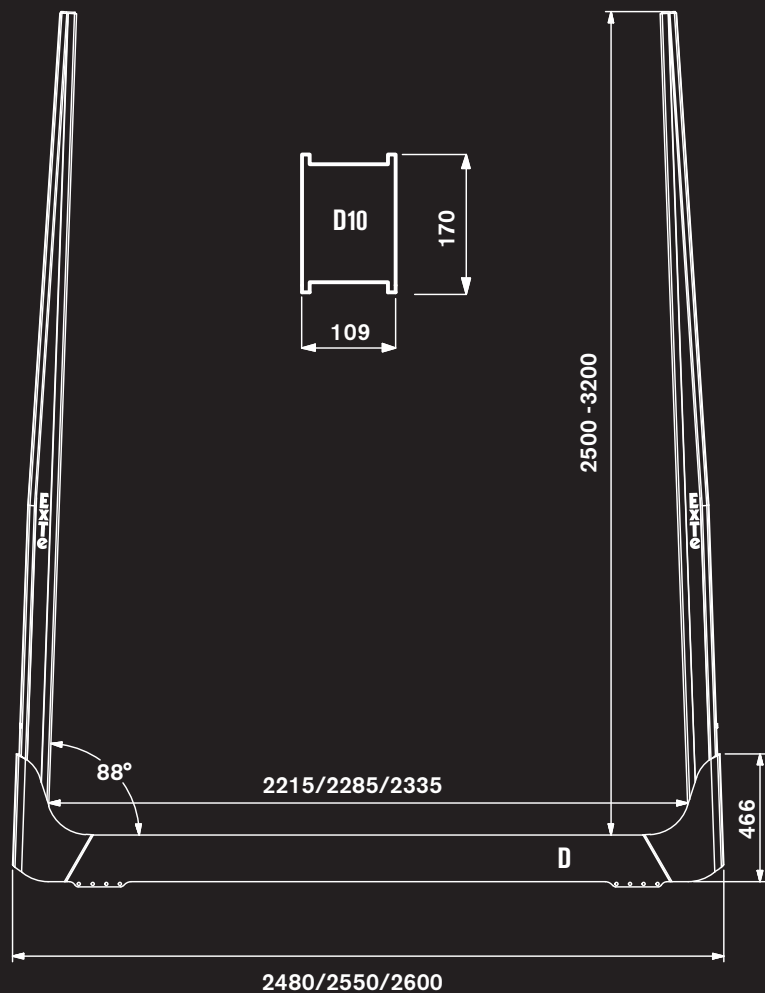
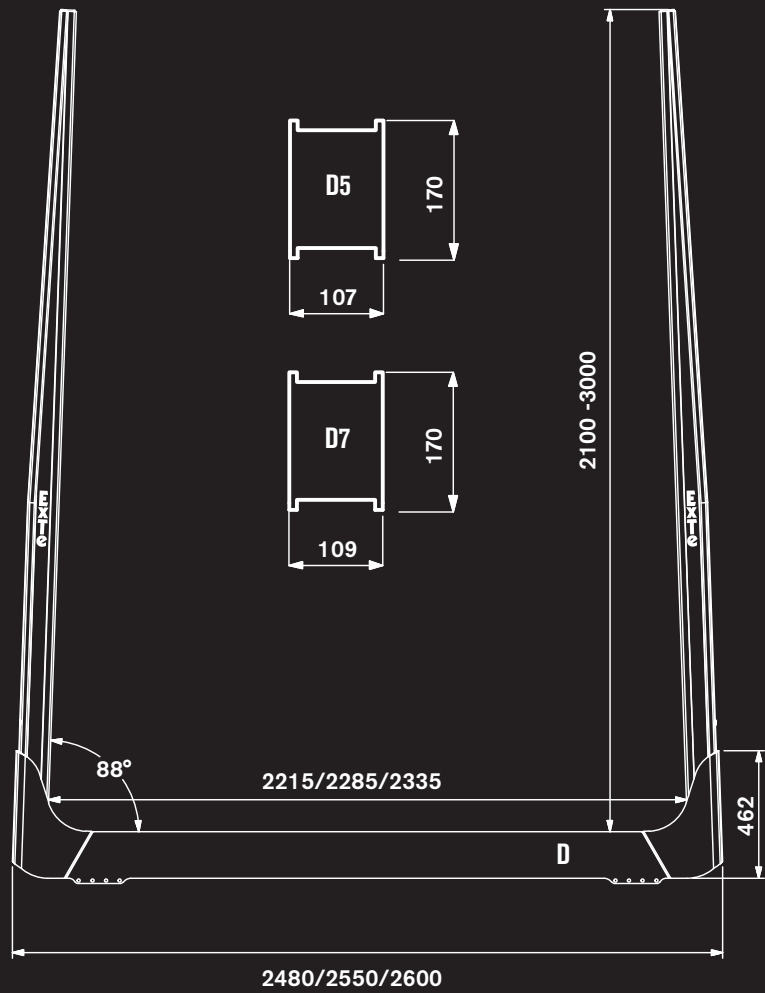

SAFETY IS OUR BRAND.

ExTe is the world's leading manufacturer and supplier of timber bunks and automatic tensioners. For more than 100 years, we have been developing and delivering products for safely securing the timber loads being transported along our roads and railways.



MORE INFORMATION:

Please visit our website www.exte.se for further technical information and installation instructions for our timber bunks and tensioners. Download a copy from our website or order a printed copy by calling +46 (0)651-175 00 or sending an email to sales@exte.se

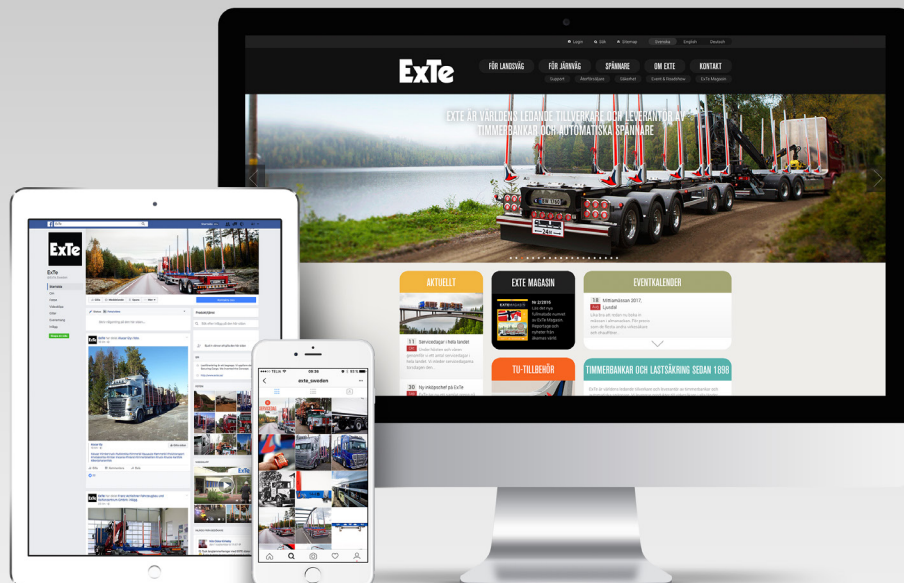

facebook.com/exte.sweden



[@exte_sweden](https://instagram.com/exte_sweden)



youtube.com/user/ExTeSwe